



Lavalier microphones

For clear speech and maximum mobility

PDF export of the original HTML manual



Contents

1. Preface.....	3
2. Product information.....	4
Product overview.....	4
Delivery includes.....	10
Accessories.....	12
3. Instruction manual.....	13
ME 2.....	13
ME 4.....	15
MKE Essential.....	17
MKE 1.....	18
MKE 2.....	20
MKE 40.....	23
Cleaning and maintenance.....	25
4. Specifications.....	26
5. Regulatory information.....	34



1. Preface

PDF Export of the Original HTML Manual

This PDF document is an automatic export of an interactive set of HTML manuals. Some content and interactive elements may not be included in the PDF because they cannot be displayed in this format. In addition, automatically generated page breaks may cause related content to be slightly shifted. We can therefore only guarantee the completeness of the information in the HTML manual and recommend using it. You can find it in the Documentation Portal at www.sennheiser.com/documentation.



2. Product information

All information about the lavalier microphones and available accessories at a glance.

Product overview

Information about the products and their variants.

ME 2

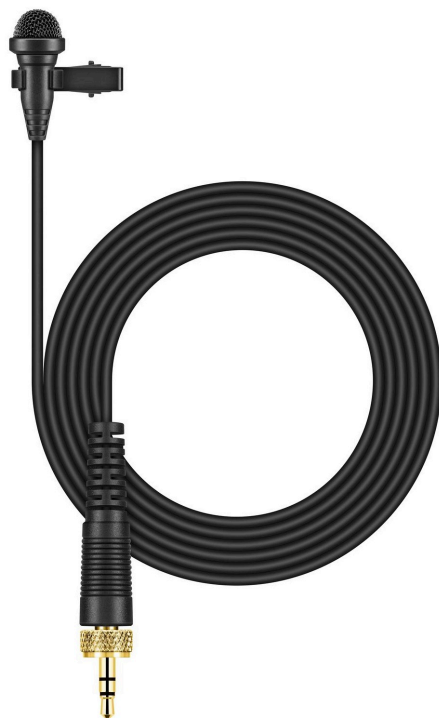

Art. no. 508935

Small omni-directional clip-on microphone for speech and vocal applications. High speech intelligibility.

i You can find more detailed information about the ME 2 in the following sections:

- **Startup and operation:** [ME 2](#)
- **Specifications:** [ME 2](#)



ME 4



Art. no. 508936

Small cardioid clip-on microphone especially for speech applications in noisy environment. Feedback-rejecting.

i You can find more detailed information about the ME 4 in the following sections:

- **Startup and operation:** [ME 4](#)
- **Specifications:** [ME 4](#)



MKE Essential



Variant	Connector	Art. no.
MKE Essential (Black EW)	3,5 mm jack	508249
MKE Essential (Beige EW)	3,5 mm jack	508250
MKE Essential (Black 3-Pin)	3-Pin SE	508251
MKE Essential (Beige 3-Pin)	3-Pin SE	508252

The MKE Essential (omnidirectional) is designed for demanding everyday use on live stages.

i You can find more detailed information about the MKE Essential in the following sections:

- **Startup and operation:** [MKE Essential](#)
- **Specifications:** [MKE Essential](#)



MKE 1

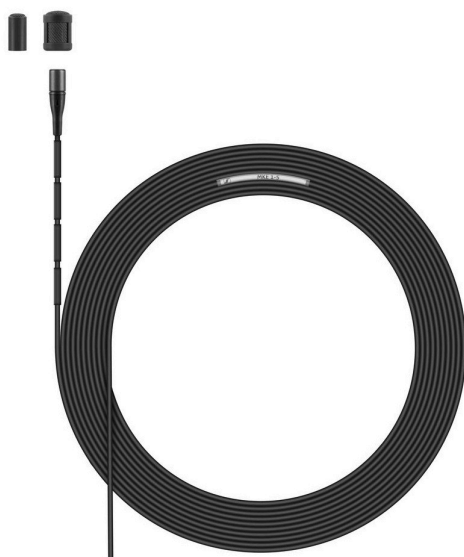

Variant	Connector	Art. no.
MKE 1 (Black 3-Pin)	3-Pin SE	502167
MKE (White 3-Pin)	3-Pin SE	502833
MKE (Brown 3-Pin)	3-Pin SE	502834
MKE (Beige 3-Pin)	3-Pin SE	502168
MKE (Beige 3-Pin paintable)	3-Pin SE	502881
MKE (Black Open End)	open-ended	502046
MKE (Beige Open End)	open-ended	502169
MKE (Black EW)	3.5 mm jack	502876
MKE (Beige EW)	3.5 mm jack	502879

Ideal for musicals, live shows, and broadcasting applications. Full, natural sound and high speech intelligibility.

i You can find more detailed information about the MKE 1 in the following sections:

- **Startup and operation:** [MKE 1](#)
- **Specifications:** [MKE 1](#)



MKE 2



Variant	Connector	Art. no.
MKE 2 (Black 3-Pin)	3-Pin SE	004736
MKE 2 (Beige 3-Pin)	3-Pin SE	004739
MKE 2 (Black Open End)	open-ended	004735
MKE 2 (Beige Open End)	open-ended	004738
MKE 2 (Black EW)	3,5 mm jack	009831
MKE 2 (Beige EW)	3,5 mm jack	009832
MKE 2 (Black XLR)	XLR-3	004224

High-quality, sub-miniature omni-directional clip-on lavalier microphone. For all areas of live work.

i You can find more detailed information about the MKE 2 in the following sections:

- **Startup and operation:** [MKE 2](#)
- **Specifications:** [MKE 2](#)



MKE 40



Variant	Connector	Art. no.
MKE 40 (Black 3-Pin)	3-Pin SE	003579
MKE (Black EW)	3.5 mm jack	500527

Cardioid clip-on microphone. Excellent speech intelligibility. High feedback-rejection.

i You can find more detailed information about the MKE 40 in the following sections:

- **Startup and operation:** [MKE 40](#)
- **Specifications:** [MKE 40](#)



Delivery includes

ME 2

- ME 2
- Clip
- Quick Guide
- Safety Guide

ME 4

- ME 4
- Clip
- Windshield
- Quick Guide
- Safety Guide

MKE Essential Omni

- MKE Essential Omni
- Windshield
- MZQ 02 microphone clamp
- Quick Guide
- Safety Guide

MKE 1

- MKE 1
- MZC 1-1 frequency response cap
- MZC 1-2 frequency response cap
- 3x make-up protection caps
- Instruction manual

MKE 2

- MKE 2
- MZC 2-1 Slip-on cap
- MZC 2-2 Slip-on cap
- 3x Make-up protection caps
- MZW 2 windshield
- MZQ 02 clip
- Quick Guide
- Safety Guide



MKE 40

- MKE 40
- Windshield MZW 40 black
- Windshield MZW 40 grey
- MZM 2/MZM 10 magnetic mount set
- Clip, black
- Instruction manual



Accessories

MZ 1



Accessory kit for the MKE 1

Art. no. 504060

MZW 02

Foam windshield for the MKE 2

Art. no. 578819

MZM 10



Magnetic mount set with magnet clip (MZM 2) for MKE 2, MKE 40 and MKE Essential

Art. no. 001866



3. Instruction manual

Information about starting up, operating and cleaning the microphones.

ME 2

To attach the microphone to the clip:

- ▶ Attach the microphone to the clip as shown in the illustration.

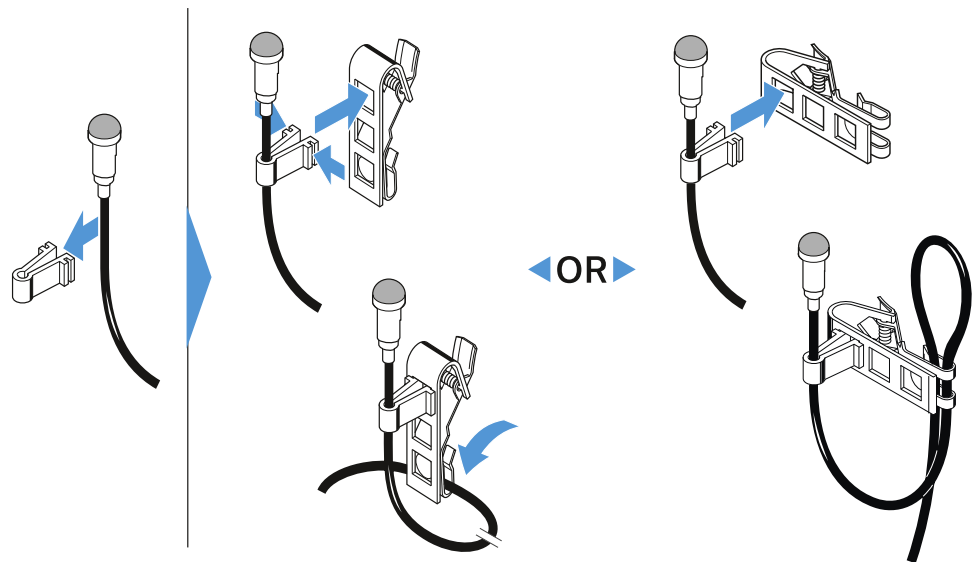



To connect the microphone:

- ▶ Inset the cable's plug into the socket on the bodypack transmitter.
- ▶ Screw the plug's coupling ring onto the audio socket thread of the bodypack transmitter.

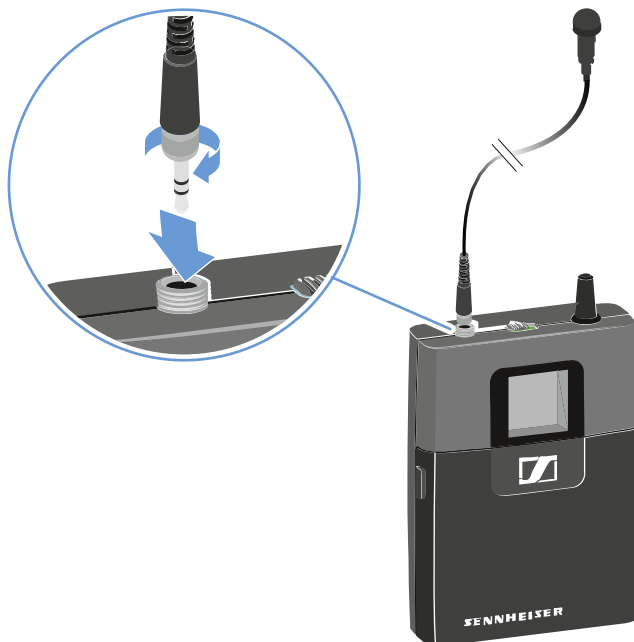

To attach the microphone:

- ▶ Attach the microphone to your clothing, keeping a distance of 25 cm (10") from your mouth.

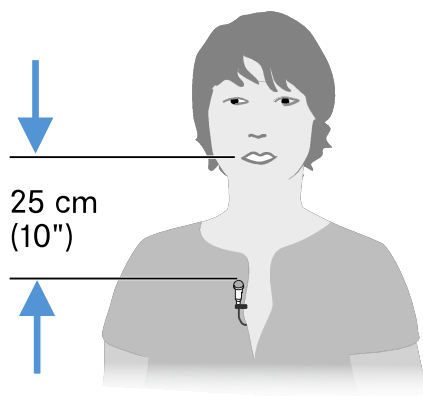



ME 4

To attach the microphone to the clip:

- ▶ Attach the microphone to the clip as shown in the illustration.

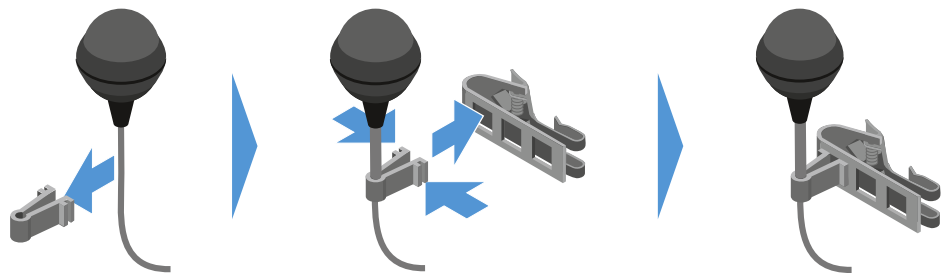

To connect the microphone:

- ▶ Inset the cable's plug into the socket on the bodypack transmitter.
- ▶ Screw the plug's coupling ring onto the audio socket thread of the bodypack transmitter.

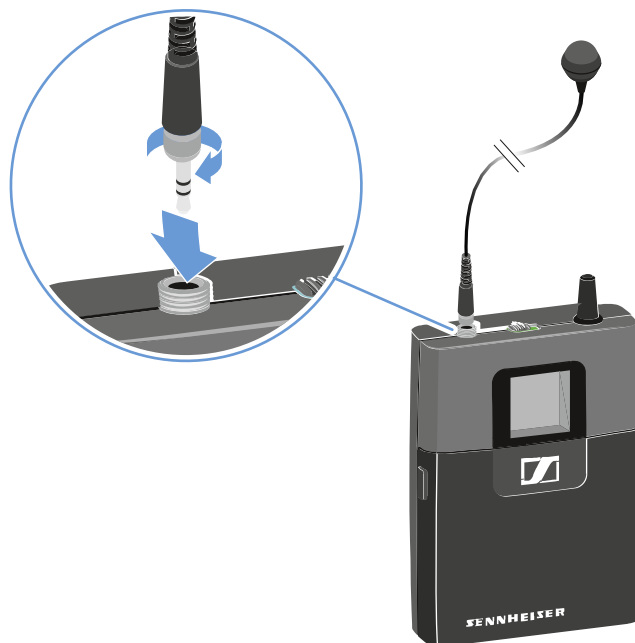



To attach the microphone:

- ▶ Attach the microphone to your clothing, keeping a distance of 25 cm (10") from your mouth.

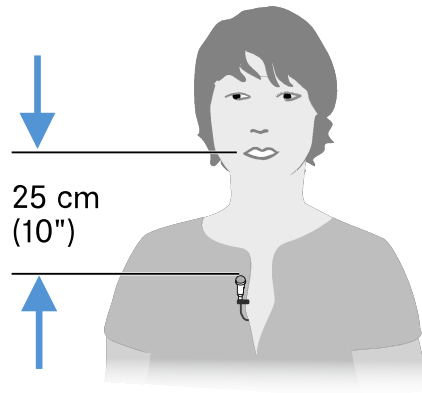

To use the windshield:

- ▶ Slide the windshield over the microphone head.

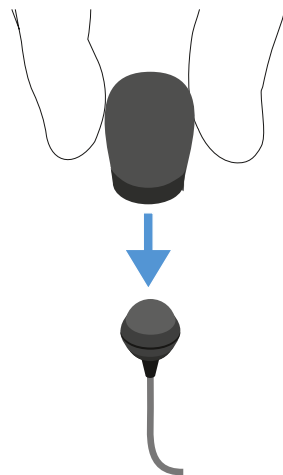



MKE Essential

To attach the microphone to the clip:

- ▶ Attach the microphone to the clip as shown in the illustration.

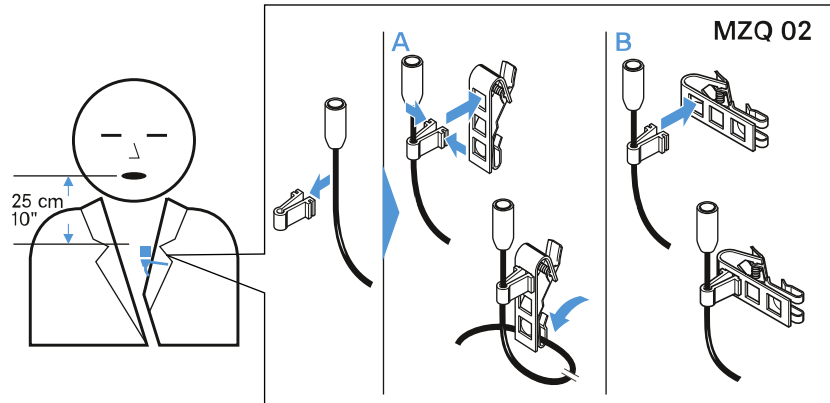

To attach the microphone to the magnetic holder MZM 10 (optional accessory):

- ▶ Slide the microphone into the magnetic clip MZM 2 (optional accessory).
- ▶ Place the magnetic clip onto the magnetic holder (MZM 10).
- ▶ Put the strap around your neck.

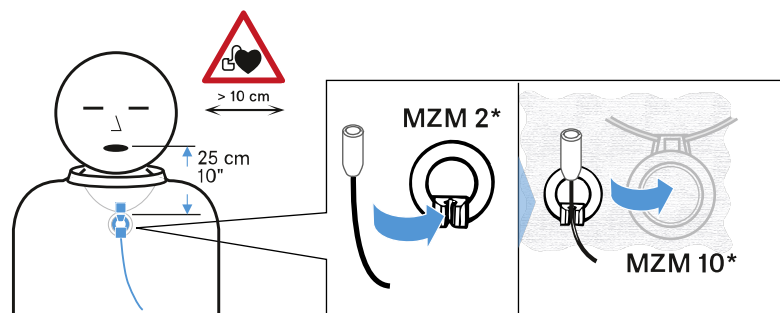

To use the windshield:

- ▶ Slide the windshield over the microphone head.

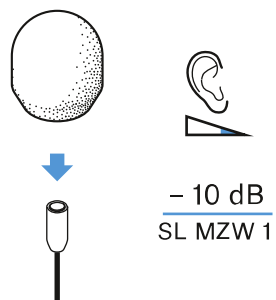



MKE 1

To use the frequency response caps:

- i** These caps allow you to adjust the treble response of the microphone (see specifications [MKE 1](#)).
The MZC 1-2 attenuates wind noise by approx. 15 dB and provides an extended protection against the ingress of moisture.

- ▶ Slip the cap of your choice onto the microphone until it locks into place.

To use the make-up protection:

- ▶ When putting on make-up or hair spray, protect the MKE 1 by slipping the make-up protector onto the microphone (with or without frequency response cap).

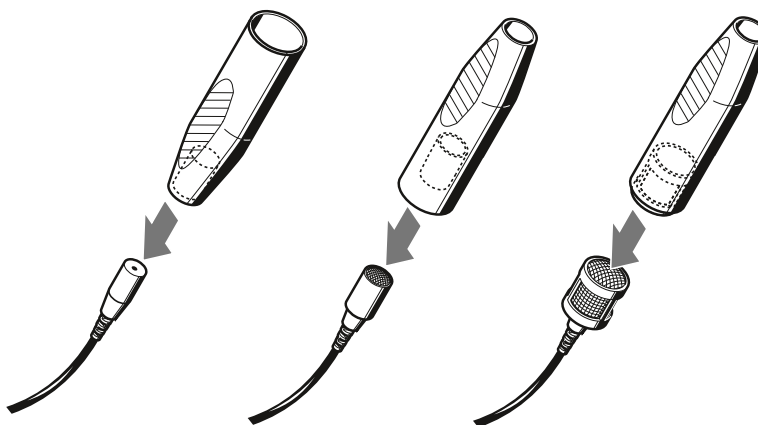

- ▶ Only remove the make-up protector after makeup has been completed.



To attach the microphone:

i Use the optional [MZ 1](#) accessory kit, that offers multiple and secure attachment possibilities.

▶ Attach the microphone at the desired position.

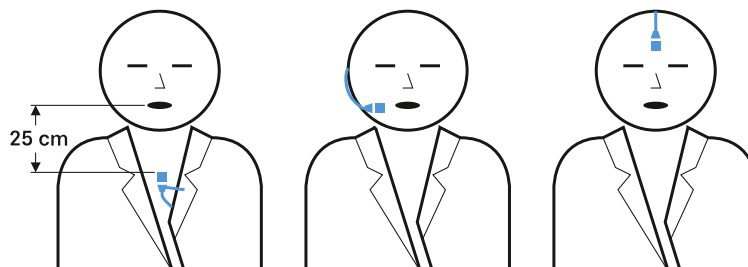



MKE 2

To use the frequency response caps:

- i** These caps allow you to adjust the treble response of the microphone (see specifications [MKE 2](#)).

- ▶ Slip the cap of your choice onto the microphone until it locks into place.

To use the make-up protection:

- ▶ When putting on make-up or hair spray, protect the MKE 2 by slipping the make-up protector onto the microphone.

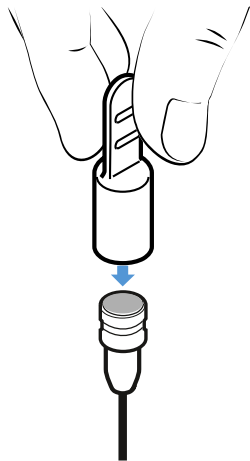

- ▶ Only remove the make-up protector after makeup has been completed.



To attach the microphone to the clip:

- ▶ Attach the microphone to the clip as shown in the illustration.

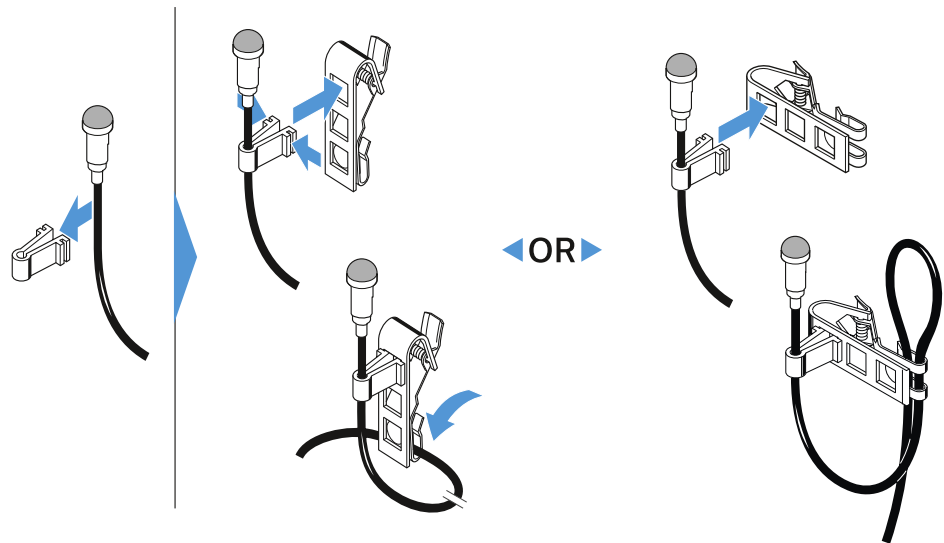

To attach the microphone to the magnetic holder [MZM 10](#):

- ▶ Slide the microphone into the magnetic clip MZM 2.
- ▶ Place the magnetic clip onto the magnetic holder (MZM 10).
- ▶ Put the strap around your neck.

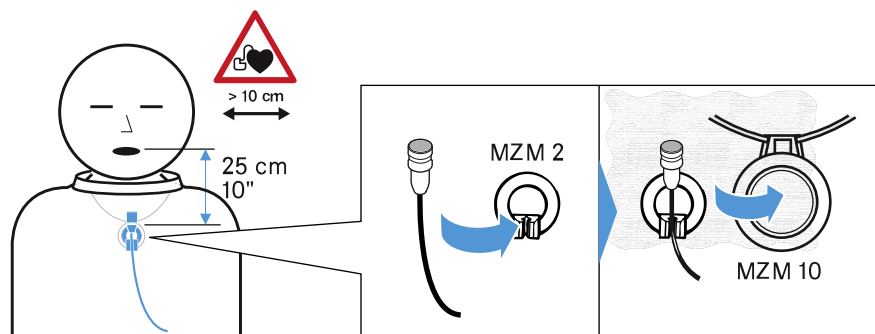



To attach the microphone:

- ▶ Attach the microphone at the desired position.

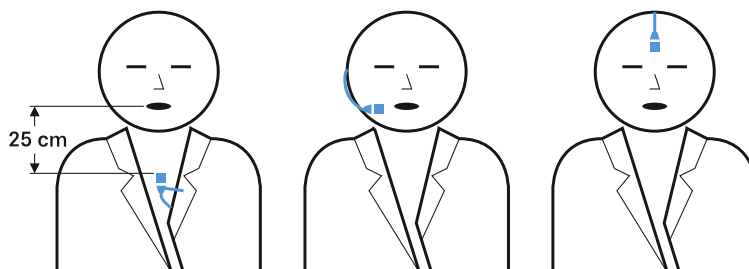

To use the windshield:

- ▶ Slide the windshield over the microphone head.

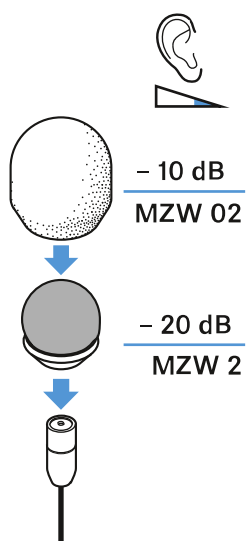



MKE 40

To attach the microphone to the clip:

- ▶ Attach the microphone to the clip as shown in the illustration.

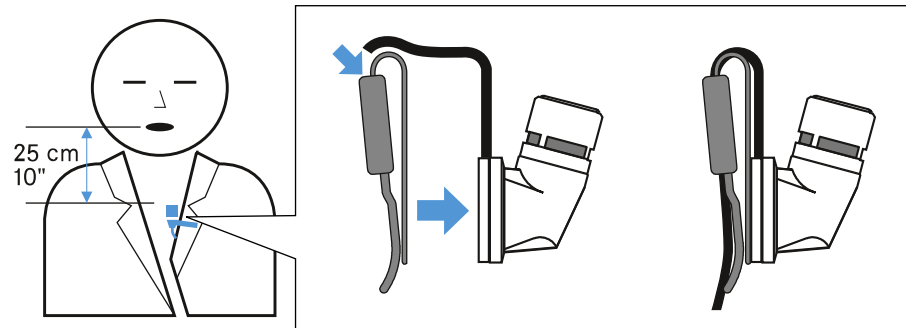

To attach the microphone to the magnetic holder **MZM 10**:

- ▶ Slide the microphone into the magnetic clip MZM 2.
- ▶ Place the magnetic clip onto the magnetic holder (MZM 10).
- ▶ Put the strap around your neck.

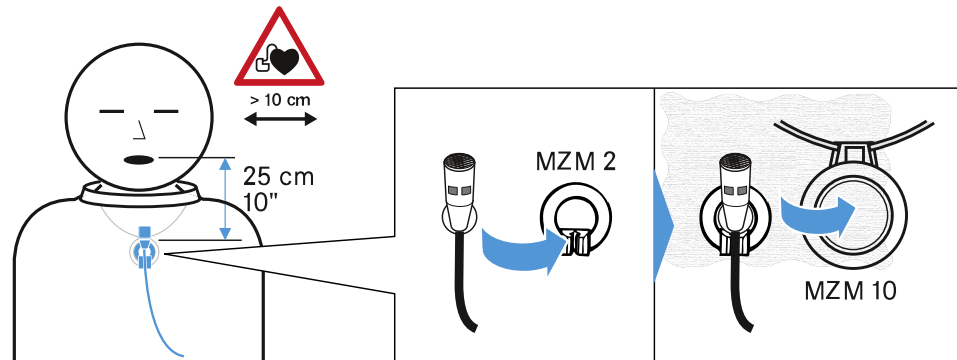



To use the windshield:

- ▶ Slide the windshield over the microphone head.

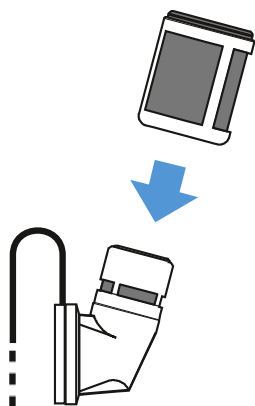



Cleaning and maintenance

Note the following information when cleaning and maintaining the products.

NOTICE



Liquids can damage the electronics of the product

Liquids entering the product housing can cause a short-circuit and damage the electronics.

- ▶ Keep all liquids away from the products.
- ▶ Do not use any solvents or cleansing agents.
- ▶ Disconnect the mains-operated products from the power supply system and remove rechargeable batteries and batteries (if present) before you begin cleaning.
- ▶ Clean all products only with a soft, dry cloth.



4. Specifications

All specifications at a glance.

ME 2

Transducer principle

- pre-polarized condenser microphone

Pick-up pattern

- omni-directional

Sensitivity (free field, no load) (1 kHz)

- 17 mV/Pa

Max. SPL at 1 kHz

- 130 dB

Frequency response

- 50 to 18,000 Hz

Equivalent noise level A-weighted

- 32 dB

Connector

- 3.5 mm jack

Cable length

- approx. 1.60 m

Microphone capsule

- \varnothing 10.5 mm

Supply voltage

- 10 V

Connector assignment

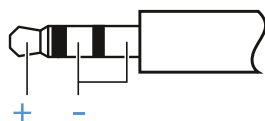

ME 4

Transducer principle

- pre-polarized condenser microphone

Pick-up pattern

- cardioid

Sensitivity (free field, no load) (1 kHz)

- 40 mV/Pa

Max. SPL at 1 kHz

- 120 dB

Frequency response

- 50 to 18,000 Hz

Equivalent noise level A-weighted

- 31 dB

Connector

- 3.5 mm jack

Cable length

- approx. 1.60 m

Microphone capsule

- \varnothing 13 mm

Supply voltage

- 10 V

Connector assignment

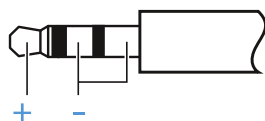

MKE Essential

Pick-up pattern

- omni-directional

Frequency response

- 20 - 20,000 Hz

Sensitivity in free field, no load (1 kHz)

- 5 mV, Pa \pm 3.5 dB

Nominal impedance

- 1 k Ω

Min. terminating impedance

- 4.7 k Ω

Equivalent noise level:

- A weighted: 28 dB
- CCIR weighted: 41 dB

Max. sound pressure level

- 140 dB

Connector

- 3.5 mm jack or 3-Pin SE

Cable length

- 1.6 m

Microphone capsule

- \varnothing 4.8 mm



Weight

- 16 g

Frequency response capsule only

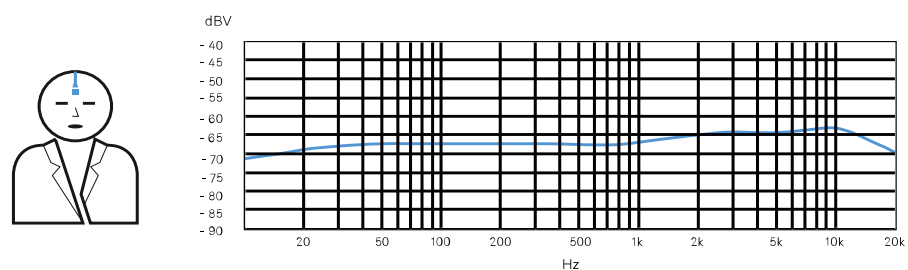
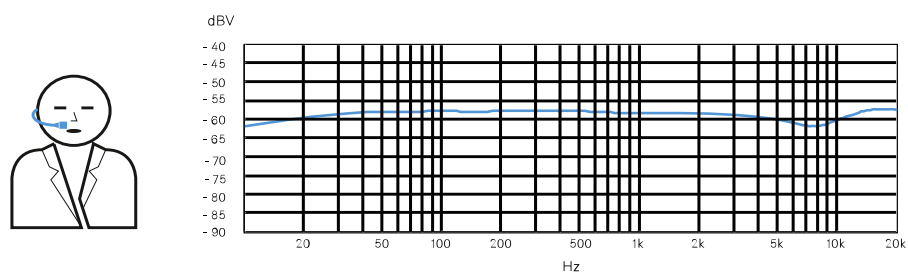
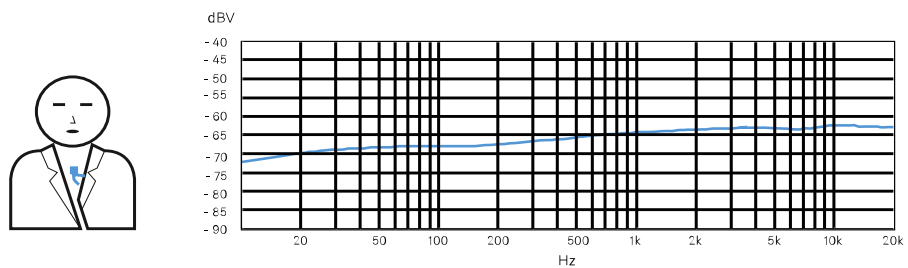

MKE 1

Transducer principle

- pre-polarized condenser microphone

Pick-up pattern

- omni-directional

Sensitivity (free field, no load) (1 kHz)

- 5 mV/Pa, ± 2.5 dB

Max. SPL at 1 kHz

- 142 dB



Frequency response

- 20 to 20,000 Hz \pm 2,5 dB

Equivalent noise level

- A weighted: 27 dB
- CCIR weighted: 39 dB

Connector

- 3-Pin SE or 3.5 mm jack or open-ended cable

Cable length

- approx. 1.60 m

Microphone capsule

- \varnothing 3.3 mm

Weight

- 0.1 g

Connector assignment with open-ended cable

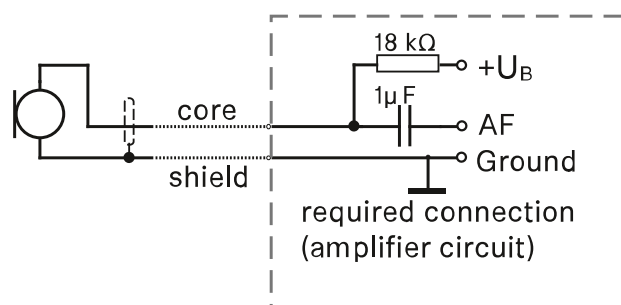

MKE 2

Transducer principle

- pre-polarized condenser microphone

Pick-up pattern

- omni-directional

Sensitivity (free field, no load) (1 kHz)

- 5 mV/Pa, \pm 3 dB



Max. SPL at 1 kHz

- 142 dB

Frequency response

- 20 to 20,000 Hz \pm 3 dB

Equivalent noise level

- A weighted: 26 dB
- CCIR weighted: 39 dB

Connector

- 3-Pin SE or 3.5 mm jack or XLR-3 or open-ended cable

Cable length

- approx. 1.60 m

Frequency response

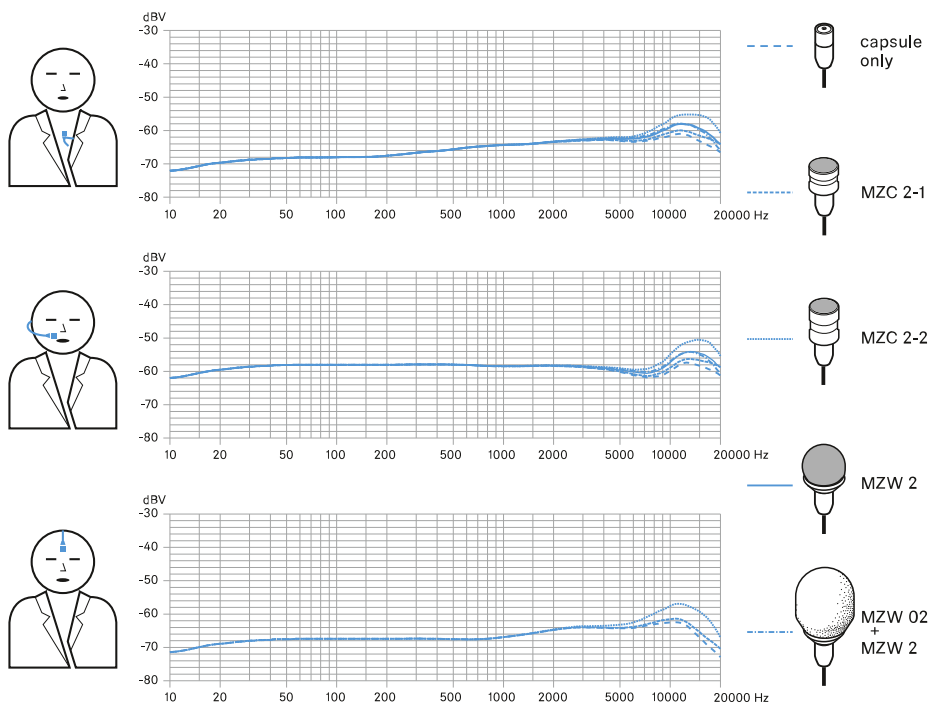

MKE 40

Transducer principle

- pressure gradient transducer



Pick-up pattern

- cardioid

Sensitivity (free field, no load) (1 kHz)

- 42 mV/Pa, ± 2.5 dB (1 kHz)

Nominal impedance

- approx. 3 k Ω

Min. terminating impedance

- 15 k Ω

Max. SPL at 1 kHz

- 118 dB

Frequency response

- 40 to 20,000 Hz

Equivalent noise level

- A weighted: 27 dB
- CCIR weighted: 37 dB

Connector

- 3-Pin SE or 3.5 mm jack

Cable length

- MKE 40-4: approx. 1.60 m
- MKE 40-ew: approx. 1.10 m

Dimensions

- \varnothing 12 mm, length: 26 mm

Polar pattern

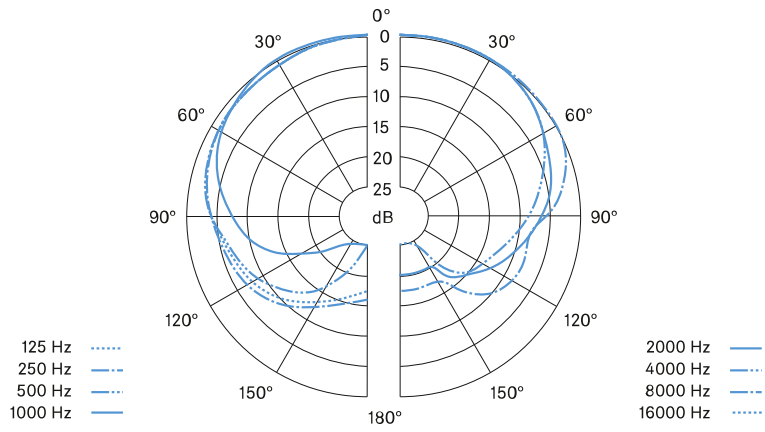

Frequency response

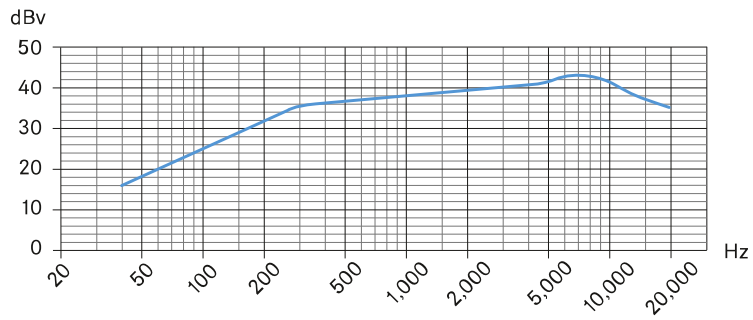



5. Regulatory information

Information on manufacturer declarations, environmental and disposal notices, and terms of use.

Model:

- ME 2
- ME 4
- MKE 1 = MKE 1 (Black Open End), MKE 1 (Black 3-Pin), MKE 1 (Beige 3-Pin), MKE 1 (Beige Open End), MKE 1 (White 3-Pin), MKE 1 (Brown 3-Pin), MKE 1 (Black EW), MKE 1 (Beige EW), MKE 1 (Beige 3-Pin Paintable)
- MKE 2 = MKE 2 Black EW, MKE 2 Beige EW, MKE 2 Black 3-Pin, MKE 2 Beige 3-Pin, MKE 2 Black open end, MKE 2 Beige open end, MKE 2 Black XLR
- MKE 40 = MKE 40 Black 3-Pin, MKE 40 Black EW
- MKE Essential = MKE Essential Black EW, MKE Essential Beige EW, MKE Essential Black 3-Pin, MKE Essential Beige 3-Pin

Warranty

Sennheiser electronic SE & Co. KG gives a warranty of 24 months on these products.

For the current warranty conditions, please visit our website at [sennheiser.com](https://www.sennheiser.com) or contact your Sennheiser partner.

In the US please contact:

Sennheiser Electronic Corporation

1 Enterprise Drive, Old Lyme, CT 06371

www.sennheiser.com

Warranty for Australia and New Zealand only

Sennheiser Australia Pty Ltd provides a warranty of 24 months on these products. For the current warranty conditions, visit Sennheiser website: Australia: [sennheiser.com](https://www.sennheiser.com), New Zealand: [sennheiser.com](https://www.sennheiser.com)

Sennheiser goods come with guarantees that cannot be excluded under Australian and New Zealand Consumer law. You are entitled to a replacement or refund for a major failure and compensation for any other reasonably foreseeable loss or damage. You are also entitled to have the goods repaired or replaced if the goods fail to be of acceptable quality and the failure does not amount to a major failure.

This warranty is in addition to other rights or remedies under law. Nothing in this warranty excludes, limits or modifies any remedy available to be consumer which is granted by law.

To make a claim under this contract, raise a case via Sennheiser website. Australia: [sennheiser.com/support](https://www.sennheiser.com/support), New Zealand: [sennheiser.com/support](https://www.sennheiser.com/support)



All expenses of claiming the warranty will be borne by the person making the claim.

Sennheiser international warranty is provided by: Sennheiser Australia Pty Ltd (ABN 68 165 388 312) Level 14, Tower A Zenith Building, 821 Pacific Highway, Chatswood NSW 2067, Australia

Europe



In compliance with the following requirements

- Regulation (EU) 2023/988 on general product safety
- WEEE Directive (2012/19/EU)

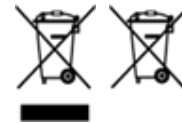

Italy:

ME 2, ME 4

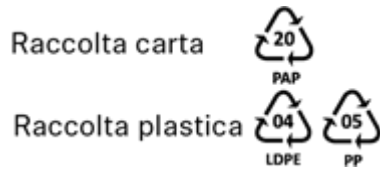

MKE 1, MKE 2, MKE Essential

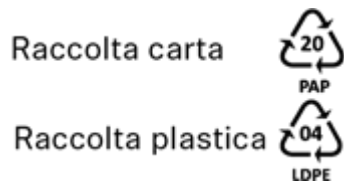

MKE 40

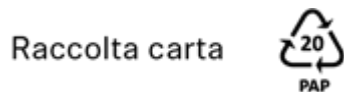

France:

ME 2, ME 4, MKE 1, MKE 2, MKE Essential

FR

- + Carton d'emballage
- + Sac plastique PE
- + Notice d'emploi en papier



MKE 40:

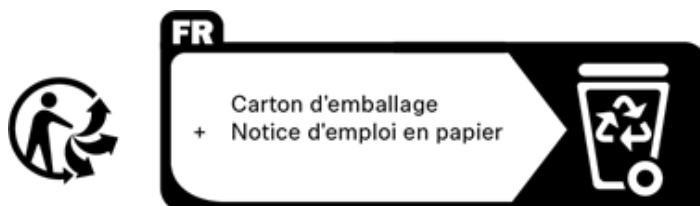

Notes on disposal

The symbol of the crossed-out dumpster on the product, the (rechargeable) battery (if applicable) and/or the packaging indicates that these products must not be disposed of with normal household waste, but must be disposed of separately at the end of their service life. For the packaging, follow the regulations in your country for separating waste. Improper disposal of packaging materials can be harmful to your health and the environment.

The separate collection of waste electrical and electronic equipment, (rechargeable) batteries (if applicable) and packaging is intended to promote reuse and recycling and to prevent negative impacts on public health and the environment, for example due to hazardous substances contained in these products. At the end of their service life, recycle electrical and electronic equipment and (rechargeable) batteries so that their materials can be reused and to prevent environmental pollution.

If (rechargeable) batteries can be removed without destroying them, you are obliged to dispose of them separately (see the product's operating instructions for information on how to remove the batteries safely). Be especially careful when handling (rechargeable) batteries containing lithium, as these pose special hazards, such as the risk of fire and/or health risks if button cells are swallowed. Reduce battery waste as much as possible by using longer-life batteries or rechargeable batteries.

Further information on the recycling of these products can be obtained from your municipal administration, from the municipal collection points, or from your Sennheiser partner. You may also be able to return electrical or electronic equipment to your distributor, if they are legally required to do so. By disposing of your batteries properly, you are helping to protect public health and the environment.

EU Declaration of conformity

- RoHS Directive (2011/65/EU)
- EMC Directive (2014/30/EU)

The full text of the EU declaration of conformity is available at the following internet address: [sennheiser.com/download](https://www.sennheiser.com/download).

United Kingdom



In compliance with the following requirements



- WEEE Regulations (2013)



UK Declaration of conformity

- RoHS Regulations (2012)
- EMC Regulations (2016)

Importer: Sennheiser UK Ltd.

Pacific House, Third Avenue, Globe Park, Marlow

Buckinghamshire SL7 1EY, United Kingdom

Australia / New Zealand

MKE 2, MKE 40



Vietnam

Kể từ ngày 1 tháng 12 năm 2012, các sản phẩm được sản xuất bởi Sennheiser tuân thủ Thông tư 30/2011/TT-BCT quy định về giới hạn cho phép đối với một số chất độc hại trong các sản phẩm điện và điện tử.

China

ME 2, ME 4

China RoHS

部件名称 (Parts)	有害物质										
	铅 (Pb)	汞 (Hg)	镉 (Cd)	六价铬 (Cr6+)	多溴联苯 (PBB)	多溴二苯醚 (PBDE)	邻苯二甲酸二 (2-乙基己)酯 (DEHP)	邻苯二甲 酸丁苯酯 (BBP)	邻苯二甲 酸二丁酯 (DBP)	邻苯二甲 酸二异丁酯 (DIBP)	产品环保年限 EFUP
电路模块 (Circuit Modules)	x	o	o	o	o	o	o	o	o	o	15
电缆及电缆组件 (Cables & Cable Assemblies)	x	o	o	o	o	o	o	o	o	o	15

本表格依据 SJ/T 11364 的规定编制。
o: 表示该有害物质在该部件所有均质材料中的含量均在 GB/T 26572 规定的限量要求以下。
x: 表示该有害物质至少在该部件的某一均质材料中的含量超出 GB/T 26572 规定的限量要求。

MKE 1, MKE 2, MKE 40, MKE Essential



China RoHS 

部件名称 (Parts)	有害物质										产品环保年限 EFUP
	铅 (Pb)	汞 (Hg)	镉 (Cd)	六价铬 (Cr6+)	多溴联苯 (PBB)	多溴二苯醚 (PBDE)	邻苯二甲酸二 (2-乙基己)酯 (DEHP)	邻苯二甲 酸丁苯酯 (BBP)	邻苯二甲 酸二丁酯 (DBP)	邻苯二甲 酸二异丁酯 (DIBP)	
金属部件 (Metal parts)	x	o	o	o	o	o	o	o	o	o	15
电路模块 (Circuit Modules)	x	o	o	o	o	o	o	o	o	o	15
电缆及电缆组件 (Cables & Cable Assemblies)	x	o	o	o	o	o	o	o	o	o	15

本表格依据 SJ/T 11364 的规定编制。
 o: 表示该有害物质在该部件所有均质材料中的含量均在 GB/T 26572 规定的限量要求以下。
 x: 表示该有害物质至少在该部件的某一均质材料中的含量超出 GB/T 26572 规定的限量要求。

